



**AQUALINE**  
MARINE LIMITED

**Head Office:**  
Hanbury Wharf  
Droitwich  
Worcestershire  
WR9 7DU  
United Kingdom

T: 01905 771018  
F: 01905 776750

**Southern Branch:**  
Thames & Kennet Marina  
Henley Road  
Caversham Lakes  
Reading, Berks.  
RG4 6LQ

T: 0118 9479 506  
F: 0118 9479 925

A dining furniture option offers the ability to seat four. This folds neatly away under the gunwale to maximise space.

The luxuriously appointed bathroom can include a full sized bath with shower.

A bow thruster can be fitted to aid manoeuvrability when cruising and mooring.

The flexibility of the Canterbury means the boat can have up to 3 bedrooms and their position in the layout is your choice.

The spacious aft deck is ideal for entertaining, offering room for a table and chairs.

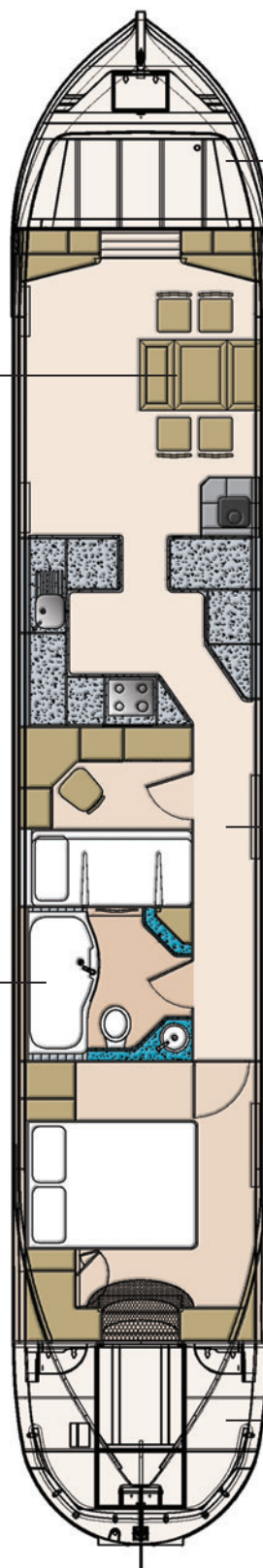

Canterbury 60

### Choose your size.

Flexibility is just one of the advantages to the Aqualine range. Amongst the many options available to you is that you can increase your chosen model up to 70ft length in 1ft stages. This could be to accommodate an extra bedroom, give you extra space or meet a mooring requirement.